

Specification Data Sheet

Rev 1.0 February 2015

Armour Home Electronics R&D Department

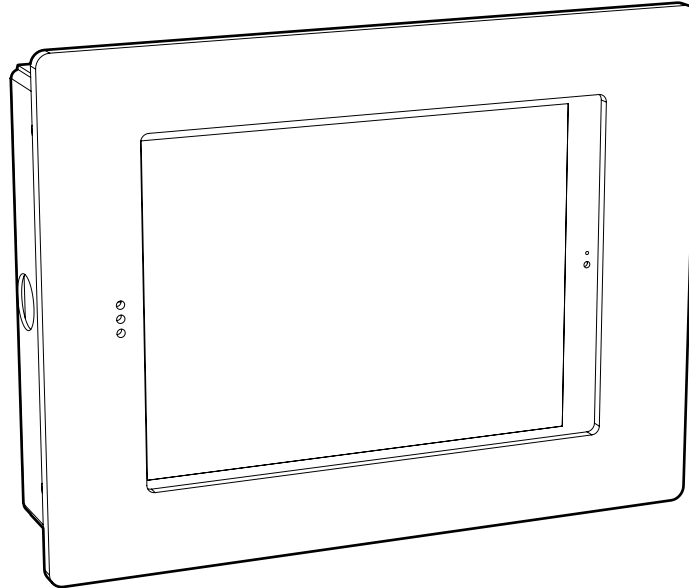

The S7 8 inch touch panel mounts allow easy installation of an iPad Mini into the wall to produce a smart in wall touch screen controller for Systemline 7. The product comes with a custom back box which can be mounted in either stud or solid wall. Different coloured magnetic fascias are available:

SN3800: White

SN3810: Black

SN3830: Primed for paint finish

SN3890: Custom finish

The product also includes connectivity for USB charging over Cat5/6 with a right angled lightning connector.

Connectivity		
iPad Mini	Apple certified Lightning connector	Right angled
USB	Cat5 punch down	30m max length

General		
Fascia Dimensions	Height: 188mm, Width: 248mm	
Net weight	0.73kg	

**FRONT**

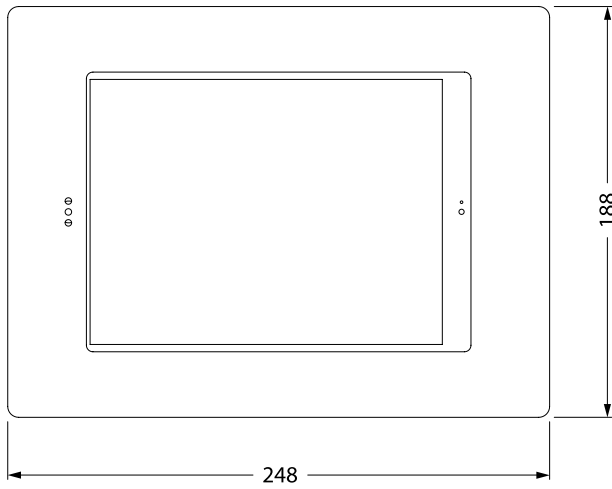

**SIDE**

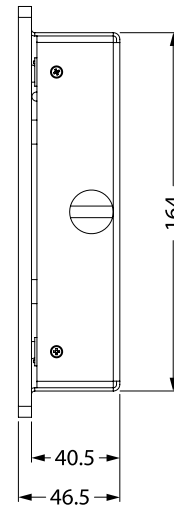

**MOUNTING HOLE**



**TOP**

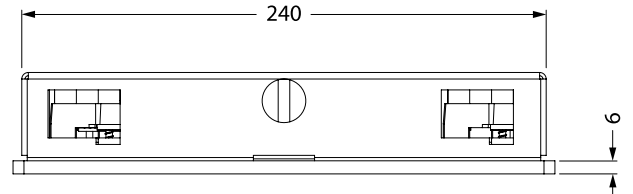

\*All measurements in mm